

HCT-WM1

1 OF 6 CHANNEL WALL MOUNT TRANSMITTER

This product is a wall mounted 433.92Mhz transmitter which is fully compatible with the Circuit Level range of receivers. Channel selection is via a 6 way DIP switch on the PCB. Simply set the switch for the channel to transmit to the ON position. The included battery will with moderate use last in excess of 2 Years. As with all RF products avoid mounting the wall plate on a metal surface as this will severely effect the performance of the product. It is best to test the mounting location before permanently fixing into position.

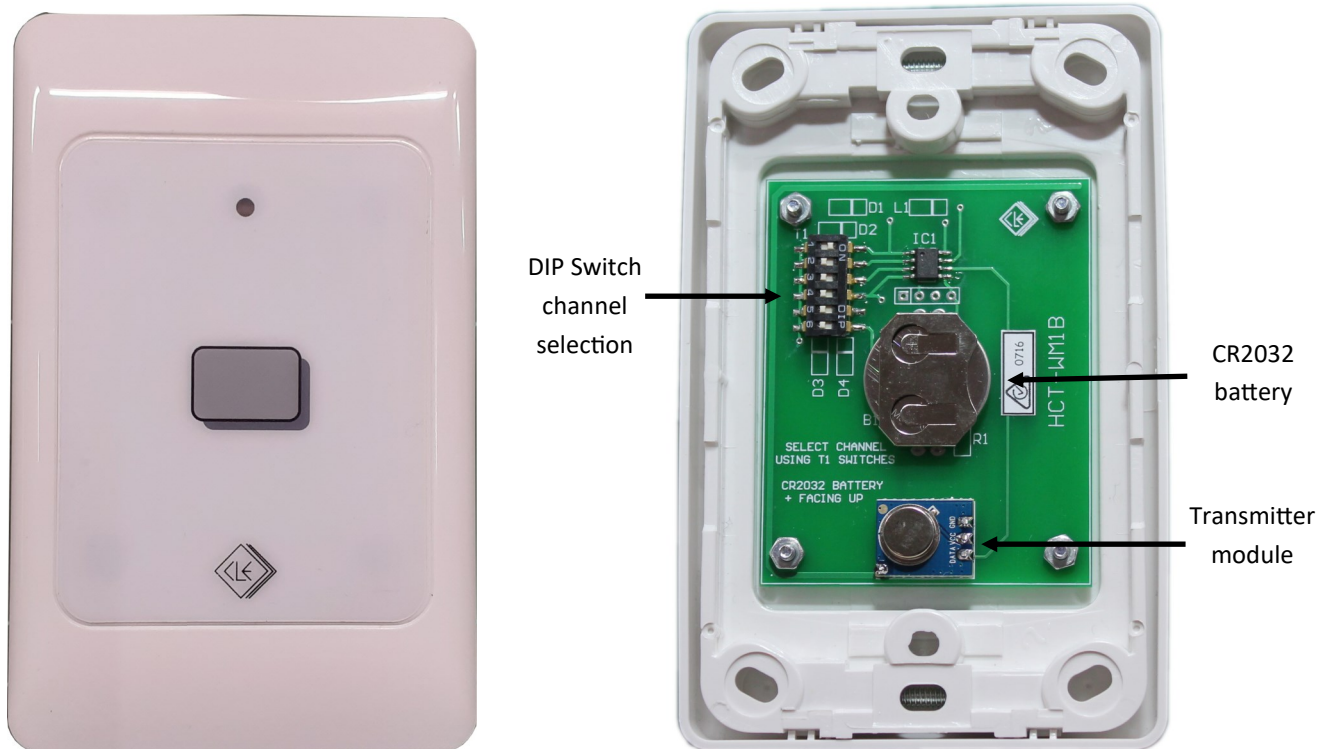

Specifications:

| | | | |
|--------------------|------------------------|---------------------|----------------------|
| Operating Voltage | 3VDC | Standby Current | 0 mA |
| Battery Type | CR2032 Lithium | Transmit Current | 11 mA |
| RF Frequency | 433.92Mhz (+/- 75Khz) | Encryption | Keeloq™ Rolling Code |
| Transmit Indicator | Blue LED | Coding Combinations | 4.2 billion |

Warranty

This product is guaranteed for a period of **2 YEARS** from date of sale. For a full warranty statement please contact your supplier or Circuit Level Electronics.



Designed & Manufactured in Australia by CIRCUIT LEVEL ELECTRONICS (Aust) Pty Ltd ABN 51 074 517 570

Information and specifications detailed in this document are subject to change without notice in the interest of product development.



HCT-WM2

2 CHANNEL WALL MOUNT TRANSMITTER

This product is a wall mounted 433.92Mhz transmitter which is fully compatible with the Circuit Level range of receivers, including WE800EV2 and RE005EV2. The supplied batteries will with moderate use last in excess of 2 Years. As with all RF products avoid mounting the wall plate on a metal surface as this will severely effect the performance of the product. It is best to test the mounting location before permanently fixing into position.

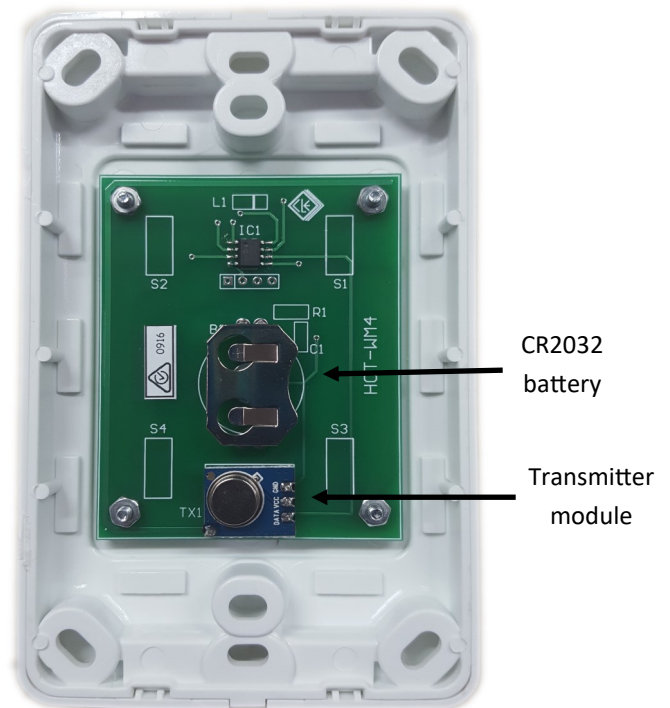

Specifications:

| | | | |
|--------------------|------------------------|---------------------|----------------------|
| Operating Voltage | 3VDC | Standby Current | 0 mA |
| Battery Type | CR2032 Lithium | Transmit Current | 10 mA |
| RF Frequency | 433.92Mhz (+/- 75Khz) | Encryption | Keeloq™ Rolling Code |
| Transmit Indicator | Blue LED | Coding Combinations | 4.2 billion |

Warranty

This product is guaranteed for a period of **2 YEARS** from date of sale. For a full warranty statement please contact your supplier or Circuit Level Electronics.



Designed & Manufactured in Australia by CIRCUIT LEVEL ELECTRONICS (Aust) Pty Ltd ABN 51 074 517 570

Information and specifications detailed in this document are subject to change without notice in the interest of product development.



HCT-WM4

4 CHANNEL WALL MOUNT TRANSMITTER

This product is a wall mounted 433.92Mhz transmitter which is fully compatible with the Circuit Level range of receivers, including WE800EV2 and RE005EV2. The supplied batteries will with moderate use last in excess of 2 Years. As with all RF products avoid mounting the wall plate on a metal surface as this will severely effect the performance of the product. It is best to test the mounting location before permanently fixing into position.

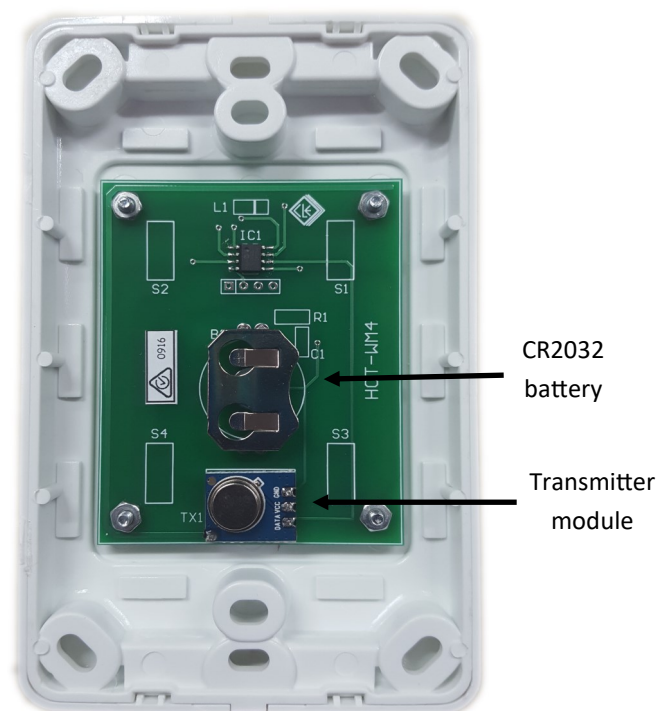

Specifications:

| | | | |
|--------------------|------------------------|---------------------|----------------------|
| Operating Voltage | 3VDC | Standby Current | 0 mA |
| Battery Type | CR2032 Lithium | Transmit Current | 10 mA |
| RF Frequency | 433.92Mhz (+/- 75Khz) | Encryption | Keeloq™ Rolling Code |
| Transmit Indicator | Blue LED | Coding Combinations | 4.2 billion |

Warranty

This product is guaranteed for a period of **2 YEARS** from date of sale. For a full warranty statement please contact your supplier or Circuit Level Electronics.



Designed & Manufactured in Australia by CIRCUIT LEVEL ELECTRONICS (Aust) Pty Ltd ABN 51 074 517 570

Information and specifications detailed in this document are subject to change without notice in the interest of product development.



HCT-WM6

6 CHANNEL WALL MOUNT TRANSMITTER

This product is a wall mounted 433.92Mhz transmitter which is fully compatible with the Circuit Level range of receivers, **excluding WE800EV2 and RE005EV2**. The supplied battery will with moderate use last in excess of 2 Years. As with all RF products avoid mounting the wall plate on a metal surface as this will severely effect the performance of the product. It is best to test the mounting location before permanently fixing into position.

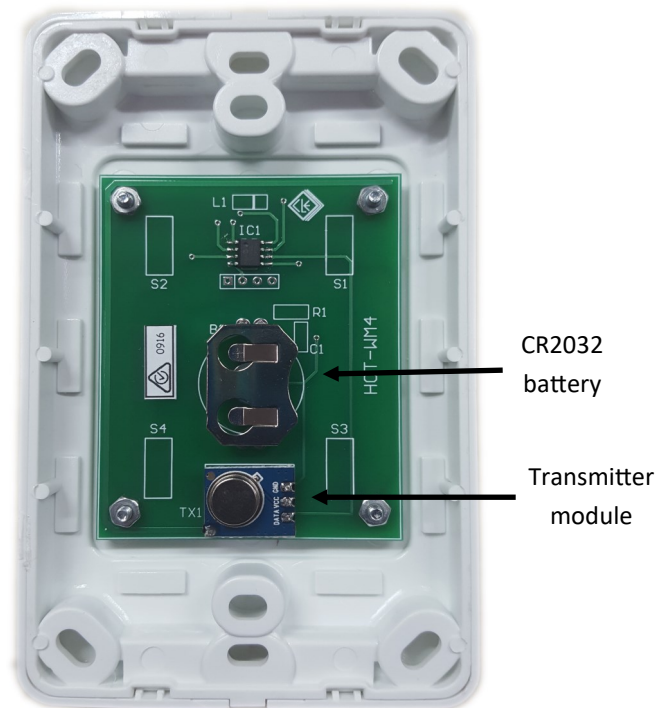

Specifications:

| | | | |
|--------------------|------------------------|---------------------|----------------------|
| Operating Voltage | 3VDC | Standby Current | 0 mA |
| Battery Type | CR2032 Lithium | Transmit Current | 10 mA |
| RF Frequency | 433.92Mhz (+/- 75Khz) | Encryption | Keeloq™ Rolling Code |
| Transmit Indicator | Blue LED | Coding Combinations | 4.2 billion |

Warranty

This product is guaranteed for a period of **2 YEARS** from date of sale. For a full warranty statement please contact your supplier or Circuit Level Electronics.



Designed & Manufactured in Australia by CIRCUIT LEVEL ELECTRONICS (Aust) Pty Ltd ABN 51 074 517 570

Information and specifications detailed in this document are subject to change without notice in the interest of product development.

